



## 10" Rough-in Full Skirt Trap and Attachment System **K-5383**

### **Features**

- 10" (254 mm) rough-in
- Converts standard 12" (305 mm) rough-in products to 10" (254 mm) configuration
- Plastic trapway



### **Codes/Standards**

ASME A112.19.2/CSA B45.1

See website for detailed warranty information.



## 10" Rough-in Full Skirt Trap and Attachment System K-5383

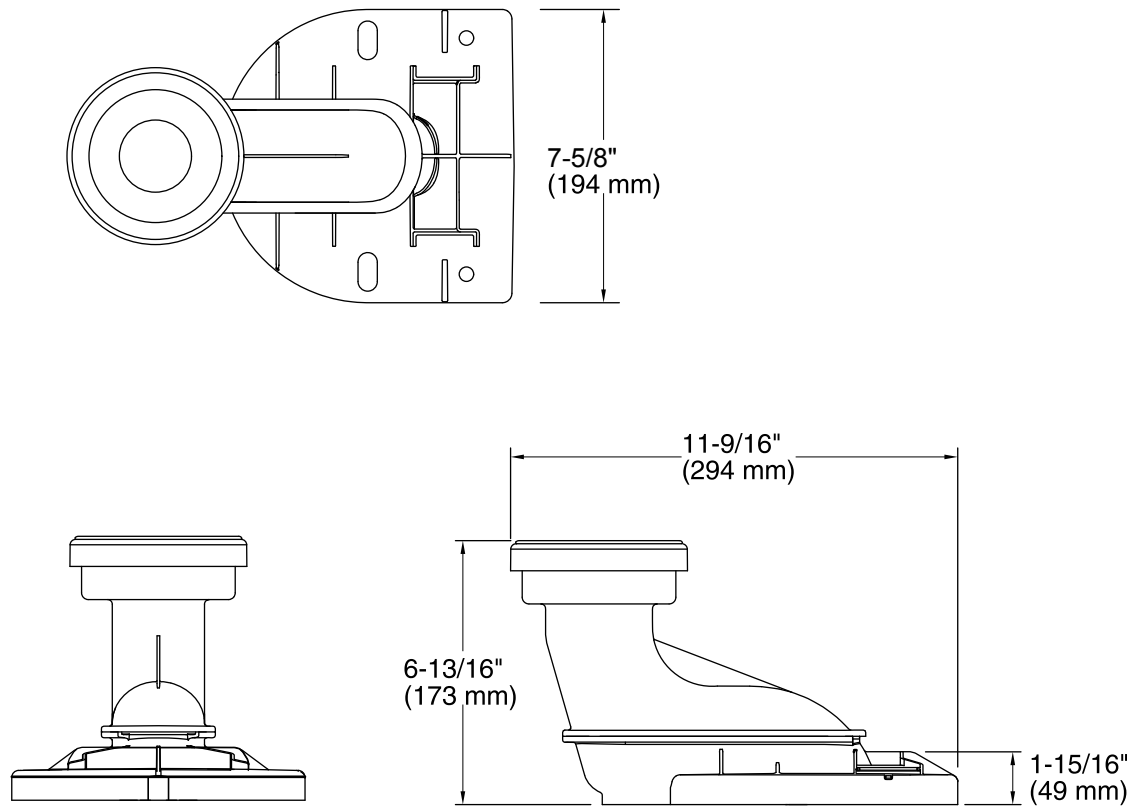

### Technical Information

All product dimensions are nominal.

Rough-in: 10" (254 mm)

### Notes

Install this product according to the installation instructions.